

PROKIT EP 110

The safety system
for temporary edge protection



Edition 07 | 2013

PERI GmbH
Formwork Scaffolding Engineering

Rudolf-Diesel-Strasse 19
89264 Weissenhorn
Germany
Tel. +49 (0) 7309.950-0
Fax +49 (0) 7309.951-0
info@peri.com
www.peri.com

Important Notes:

Without exception, all current safety regulations must be observed in those countries where our products are used.

The photos shown in this brochure feature construction sites in progress. For this reason especially safety and anchor details cannot always be considered as conclusive or final. These are subject to the risk assessment carried out by the contractor.

The systems or items shown are not necessarily available in all countries.

Safety instructions and load specifications are to be strictly observed at all times. Separate structural calculations are required for any deviations from the standard design data.

The information contained herein is subject to technical changes in the interests of progress. Errors and typographical mistakes reserved.

Content

PROKIT EP 110

- 2 The safety system
for temporary edge protection

Quick installation

- 4 Very few different system components
and self-securing posts

Flexibly mounted

- 5 Numerous possibilities
for a wide range of mounting situations

Technically sound

- 6 Reliable safety barriers
on building shells and formwork

Economically-efficient solution

- 7 Multiple re-use,
efficiently executed
- 8 Components



PROKIT EP 110

The safety system for temporary edge protection

PERI PROKIT EP 110 is the 1.10 m high, quickly-assembled fall protection for open slab edges. Complete with side mesh barrier, guardrail post and assembly feet, a more flexible application can be realized - also for complicated structural geometries. By means of clamps, the system can also be mounted to parapets or sheet pilings. Furthermore, other accessories also allow the use of the side mesh barriers on almost all PERI formwork and scaffolding systems.

■ Quick installation

Few different, lightweight system components and self-securing guardrail posts for easy assembly

■ Flexibly mounted

Range of accessories for fixing to walls and slabs, with or without drilling

■ Technically sound

Reliable fall protection for open edges on building shells as well as formwork

■ Cost-effective

High rate of utilization and efficient logistics thanks to a minimum number of re-usable components

PROKIT EP 110 provides reliable protection for open slab edges. This accelerates working operations on building shells. (The graphic shows a system visualization)

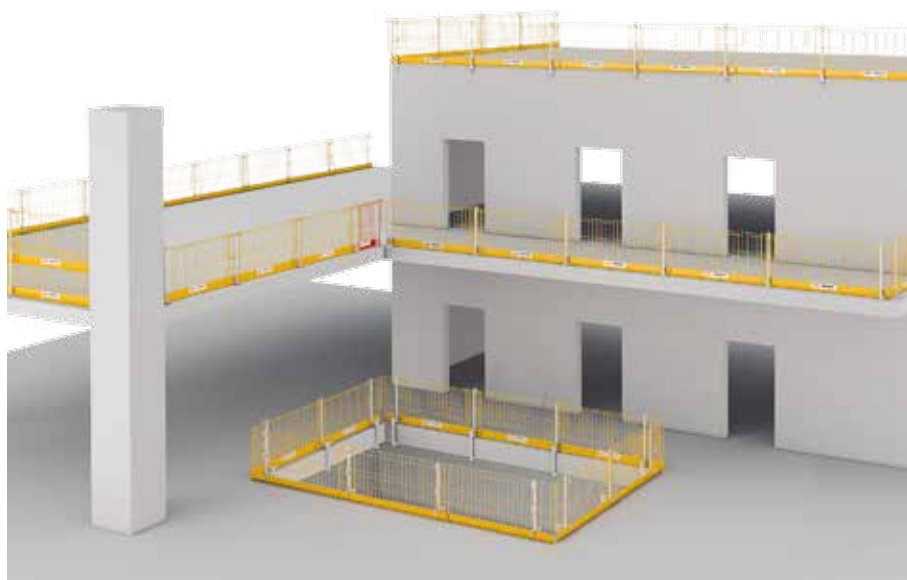

Regular fall protection can also be realized on many PERI formwork systems with PROKIT side mesh barriers. When using TRG Scaffold Brackets, for example, they can be used on MAXIMO and TRIO wall formwork.



Quick installation

Very few different lightweight system components and self-securing posts

Installing the PROKIT EP 110 anti-fall protection is uncomplicated, very quick and safe: the posts are automatically secured when inserted into the feet after which the mesh barrier is simply fixed in position.

The standard side mesh barrier is 2.60 m long and weighs less than 20 kg which ensures easy and fatigue-free handling. The large post spacing of up to 2.40 m reduces material requirements as well as assembly time. A shorter barrier with a length of 1.30 m, is used as compensation so that only small overlaps are necessary.



PROKIT Post PP

The PROKIT posts are 1.12 m high. Thanks to a simple, mechanical solution, they are immediately secured without requiring any other measures when inserted into the feet.

The side mesh barrier can be quickly suspended over the two brackets. Subsequently, the barrier is fixed to the integrated toe board by means of the bottom moveable bracket.

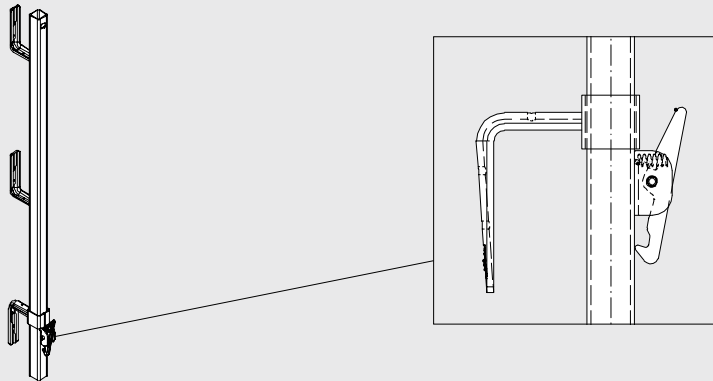

The close-meshed side mesh barriers are available in 260 cm and 130 cm lengths. The yellow or red powder coating offers excellent corrosion protection; in addition, it has a strong signal effect for hazardous areas.

Side Mesh Barrier PMB 130
powder-coated, red

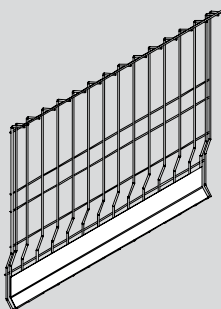

Side Mesh Barrier PMB 260
powder-coated, yellow



Flexibly mounted

Numerous possibilities

for a wide range of mounting situations

For the self-securing post, there is a range of mounting options. Depending on the requirement, there are accessories available, for example, for mounting on the slab, on the front side or on the parapets.



Slab feet and side feet can be mounted on reinforced concrete by means of PERI anchor bolts. If screw-in sleeves have been inserted into the fresh concrete, the slab foot can be mounted using standard M 16-8.8 bolts. This is a particular advantage, e.g. for concrete core activation.

PROKIT Post PP

The standard supports for the PROKIT post is the slab foot and side foot. In addition, there are various mounting supports that are simply clamped on the concrete component as well as on a sheet piling.

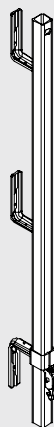

Slab Foot PDF
For mounting on the slab

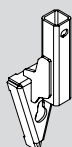

Side Foot PSF
For mounting to slab, wall or flight of stairs.

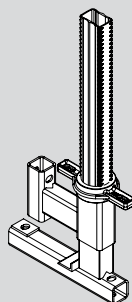

Uni-Clamp PUC
For mounting on front side of slab or parapet with a clamping range of up 45 cm

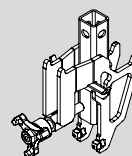

Sheet Piling Clamp
For mounting on sheet piling

Technically sound

Reliable securing of edges on building shells and formwork

PROKIT EP 110 fulfils Class A of DIN EN 13374 which requires a guardrail positioned at least 1.00 m above the working surface, an intermediate guardrail and a toe board with a minimum height of 150 mm. The system thus provides protection against falling with an inclination angle of up to 10%. Compared to the use of rope equipment, one particular advantage is considerably more freedom of movement for the construction team.

In addition, the side mesh barrier is also compatible with many PERI formwork and scaffolding systems, and correspond to EN 12811.



PROKIT EP 110 provides protection on all open edges of the working platforms of this tunnel formwork



With wall formwork, the use of the side mesh barrier is also possible as an opposing guardrail.



The side mesh barrier as anti-fall protection on a slab table which has been mounted with the appropriate guardrail posts.

Economically-efficient solution

Multiple re-use, efficiently executed

On request, the mesh barrier can be powder-coated in other standard RAL colours. Thus, the anti-fall protection can also be used as an effective advertising medium.

PROKIT system components are extremely versatile, re-usable many times and allow the highest rates of utilization. In addition, the small number of system components simplifies the entire on-site material requirements and logistics.

Furthermore, the powder coating of the side mesh barrier and the galvanizing of all the other system components provide excellent protection against corrosion thus ensuring a long service life. All of this makes PROKIT EP 110 a very worthwhile investment.

Thanks to the pallet used for storage and transport, stacking of the side mesh barriers is a very simple procedure. This minimizes storage space and transport volumes and also prevents from damage.



A total of 25 mesh barriers can be quickly and compactly accommodated in the Pallet EP 110 - in exactly the position in which they are installed on the slab edge. The pallet dimensions have been optimized for transportation by truck, have the base area of a Euro pallet and also are stackable.



Stairwell areas can be secured with handrail boards which are easy to attach to the posts.



The holding brackets on the posts have nail and screw holes already in place so that handrail boards can be quickly fixed.



With the help of the post extension and a second mesh barrier, the side protection can be increased to a height of 1.75 m.

Item no.	Weight kg		
117326	19.700	Side-Mesh-Barrier PMB	Technical Data
117327	10.500	Side-Mesh-Barrier PMB 260	Maximum distance with side-mesh-barrier: PMB
		Side-Mesh-Barrier PMB 130	260 max. 2.40 m, PMB 130 max. 1.20 m.

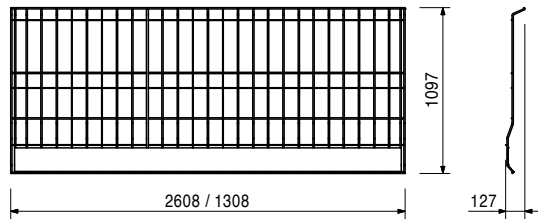
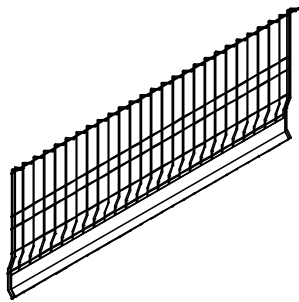

117325	4.270	Post PP	Technical Data
		For the fixation of the Side-Mesh-Barriers.	Maximum distance of posts with Side-Mesh-Barrier: PMB 260 max. 2.40 m, PMB 130 max. 1.20 m.

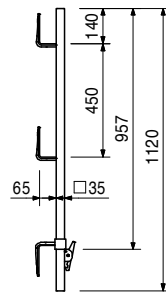

117323	1.530	Slab Foot PDF	Technical Data
		For assembly of a guardrail on or at edge slabs.	Maximum distance of posts with Side-Mesh-Barrier: PMB 260 max. 2.40 m, PMB 130 max. 1.20 m.

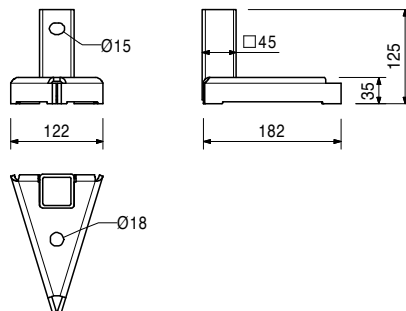
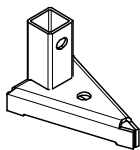

		Accessories	
117020	0.213	Anchor Bolt PERI 14 x 150	
117325	4.270	Post PP	

Item no.	Weight kg
117324	2.210

Side Foot PSF

For assembly of a guardrail on or at walls and stairs.

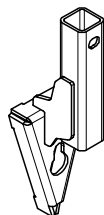

Technical Data

Maximum distance of posts with Side-Mesh-Barrier: PMB 260 max. 2.40 m, PMB 130 max. 1.20 m.

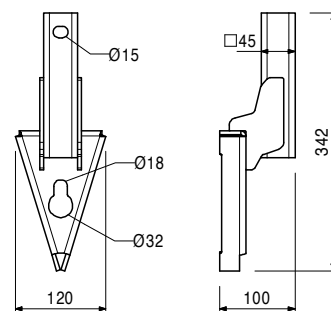

Accessories

117020	0.213
117325	4.270

Anchor Bolt PERI 14 x 150 Post PP

118660	6.610
--------	-------

Uni-Clamp PUC

For the assembly of a guardrail on the front side of slabs or on railings.

Technical Data

Maximum distance of posts with Side-Mesh-Barrier: PMB 260 max. 2.40 m, PMB 130 max. 1.20 m.

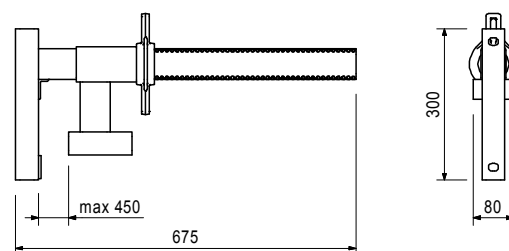
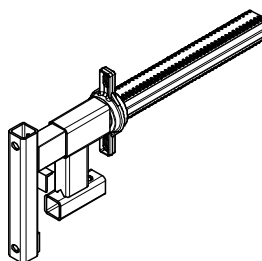

Accessories

117325	4.270
--------	-------

Post PP

126330	4.460
--------	-------

Sheet Piling Clamp PSC

For assembly of a guardrail on sheet piling.

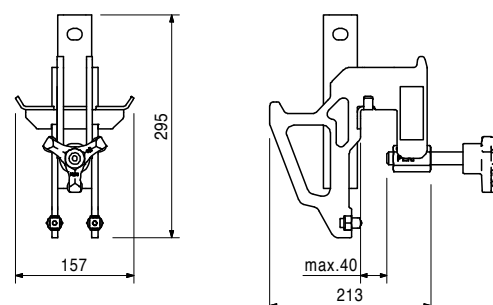
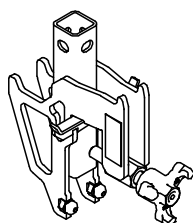

Accessories

117325	4.270
--------	-------

Post PP

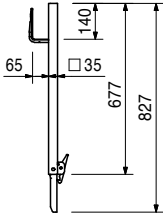
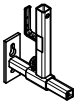
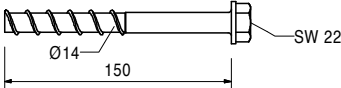
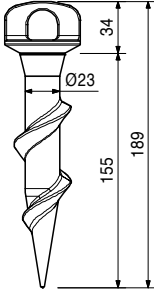
Item no.	Weight kg		
118296	2.910	Post Increase PPE For increasing the guardrail to 1.75 m.	
118670	5.030	Front Guardrail Holder ADJ PFH For mounting safety barriers to slab edges and stairs.	
117020	0.213	Accessories Anchor Bolt PERI 14 x 150	
117325	4.270	Post PP	
117020	0.213	Anchor Bolt PERI 14 x 150 Re-usable. Approval available.	
123970	0.047	Screw-On Sleeve PERI M16/164 For temporary mounting of components on reinforced concrete slabs.	
123973	0.240	Accessories Bolt ISO 4014 M16 x 130-8.8, galv.	

Item no.	Weight kg
123973	0.240

Bolt ISO 4014 M16 x 130-8.8, galv.

For assembly of Slab Foots PDF in combination with Screw-On Sleeve PERI M16/164.

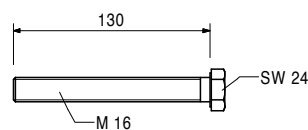
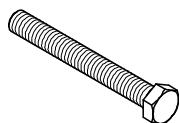

123960	70.500
--------	--------

Pallet EP 110

For stacking and transportation of 25 Side-Mesh-Barriers PMB.

Complete with

1 pc. 117560 Lashing 25 x 2550 mm

Note

Follow Instructions for Use!

Technical Data

Permissible load-bearing capacity 600 kg.

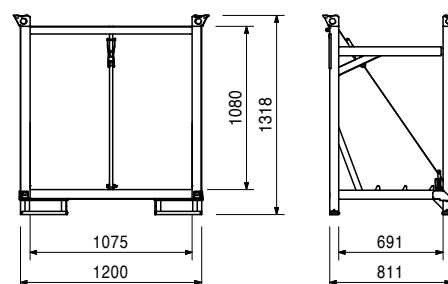
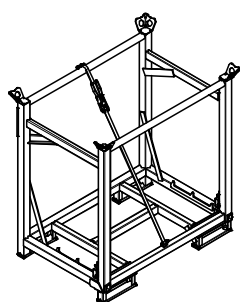



01 Germany
PERI GmbH
 Rudolf-Diesel-Strasse 19
 89264 Weissenhorn
 info@peri.com
 www.peri.com



02 France
 PERI S.A.S.
 77109 Meaux Cedex
 peri.sas@peri.fr
 www.peri.fr

03 Switzerland
 PERI AG
 8472 Ohringen
 info@peri.ch
 www.peri.ch

04 Spain
 PERI S.A.U.
 28110 Algete - Madrid
 info@peri.es
 www.peri.es

05 Belgium/Luxembourg
 N.V. PERI S.A.
 1840 Londerzeel
 info@peri.be
 www.peri.be

06 Netherlands
 PERI Holding B.V.
 5480 AH-Schijndel
 info@peri.nl
 www.peri.nl

07 USA
 PERI Formwork Systems, Inc.
 Elkridge, MD 21075
 info@peri-usa.com
 www.peri-usa.com

08 Indonesia
 PT Beton Perkasa Wijaksana
 Jakarta 10210
 bpw@betonperkasa.com
 www.peri.com

09 Italy
 PERI S.p.A.
 20060 Basiglio
 info@peri.it
 www.peri.it

10 Japan
 PERI Japan K.K.
 Tokyo 103-0015
 info@perijapan.jp
 www.perijapan.jp

11 United Kingdom/Ireland
 PERI Ltd.
 Rugby, CV23 0AN
 info@peri.ltd.uk
 www.peri.ltd.uk

12 Turkey
 PERI Kalip ve Iskeleleri Sanayi
 ve Ticaret Ltd.
 Esenyurt / İstanbul 34510
 info@peri.com.tr
 www.peri.com.tr

13 Hungary
 PERI Kft.
 1181 Budapest
 info@peri.hu
 www.peri.hu

14 Malaysia
 PERI Formwork Malaysia Sdn. Bhd.
 43300 Seri Kembangan,
 Selangor Darul Ehsan
 info@perimalaysia.com
 www.perimalaysia.com

15 Singapore
 PERI Asia Pte Ltd
 Singapore 387355
 pha@periasia.com
 www.periasia.com

16 Austria
 PERI Ges.mbh
 3134 Nußdorf ob der Traisen
 office@peri.at
 www.peri.at

17 Czech Republic
 PERI spol. s r.o.
 252 42 Jesenice u Prahy
 info@peri.cz
 www.peri.cz

18 Denmark
 PERI Danmark A/S
 2670 Greve
 peri@peri.dk
 www.peri.dk

19 Finland
 PERI Suomi Ltd. Oy
 05460 Hyvinkää
 info@perisuomi.fi
 www.perisuomi.fi

20 Norway
 PERI Norge AS
 3036 Drammen
 info@peri.no
 www.peri.no

21 Poland
 PERI Polska Sp. z o.o.
 05-860 Płochocin
 info@peri.com.pl
 www.peri.com.pl

22 Sweden
 PERI Sverige AB
 30262 Halmstad
 peri@periform.se
 www.periform.se

23 Korea
 PERI (Korea) Ltd.
 Seoul 06243
 info@perikorea.com
 www.perikorea.com

24 Portugal
 Pericofragens Lda.
 2790-326 Queijas
 info@peri.pt
 www.peri.pt

25 Argentina
 PERI S.A.
 B1625GPA Escobar – Bs. As.
 info@peri.com.ar
 www.peri.com.ar

26 Brazil
 PERI Formas e
 Escoramentos Ltda.
 Vargem Grande Paulista – SP
 info@peribrasil.com.br
 www.peribrasil.com.br

27 Chile
 PERI Chile Ltda.
 Colina, Santiago de Chile
 perichile@peri.cl
 www.peri.cl

28 Romania
 PERI România SRL
 077015 Balotești
 info@peri.ro
 www.peri.ro

29 Slovenia
 PERI Agency
 2000 Maribor
 peri.slo@triera.net
 www.peri.com

30 Slovakia
 PERI spol. s r.o.
 903 01 Senec
 info@peri.sk
 www.peri.sk

31 Australia
 PERI Australia Pty. Ltd.
 Glendenning NSW 2761
 info@periaus.com.au
 www.periaus.com.au

32 Estonia
 PERI AS
 76406 Saku vald
 Harjumaa
 peri@peri.ee
 www.peri.ee

33 Greece
 PERI Hellas Solely Owned Ltd.
 194 00 Koropi
 info@perihellas.gr
 www.perihellas.gr

34 Latvia
 PERI SIA
 2118 Salaspils novads, Rīgas rajons
 info@peri-latvija.lv
 www.peri-latvija.lv

35 United Arab Emirates
 PERI (L.L.C.)
 Dubai U.A.E.
 perillc@perime.com
 www.perime.com

36 Canada
 PERI Formwork Systems, Inc.
 Bolton, ON – L7E 1K1
 info@peri.ca
 www.peri.ca

37 Lebanon

PERI Lebanon Sarl
90416 – Jdeideh
lebanon@peri.de

44 Russian Federation

OOO PERI
142407, Noginsk District
moscow@peri.ru
www.peri.ru

51 Turkmenistan

PERI Kalıp ve İskeleleri
Aşgabat
ahmet.kadioglu@peri.com.tr
www.peri.com.tr

57 Saudi Arabia

PERI Saudi Arabia Ltd.
21463 Jeddah
info@peri.com.sa
www.peri.com.sa

64 Nigeria

PERI Nigeria Ltd.
Lagos
info@peri.ng
www.peri.ng

38 Lithuania

PERI UAB
02300 Vilnius
info@peri.lt
www.peri.lt

45 South Africa

PERI (Pty) Ltd
7600 Stellenbosch
info@peri.co.za
www.peri.co.za

52 Belorussia

IOOO PERI Belarus
220100 Minsk
info@peri.by
www.peri.by

58 Qatar

PERI Qatar LLC
P.O.Box: 31295 - Doha
info@periqatar.com
www.peri.qa

65 Oman

PERI (L.L.C.)
Muscat
perimct@perime.com
www.perime.com

39 Morocco

PERI S.A.U.
Tanger
info@peri.ma
www.peri.ma

46 Ukraine

TOW PERI
07400 Brovary
peri@peri.ua
www.peri.ua

53 Croatia

PERI oplate i skele d.o.o.
10 250 Lučko-Zagreb
info@peri.com.hr
www.peri.com.hr

59 Algeria

PERI PERI
Kouba 16092, Alger
info@peri.com
www.peri.com

66 Colombia

PERI S.A.S. Colombia
Briceño, Cundinamarca
peri.colombia@peri.com.co
www.peri.com.co

40 Israel

PERI Formwork
Engineering Ltd.
Rosh Ha'ayin, 48104
info@peri.co.il
www.peri.co.il

47 Egypt

Egypt Branch Office
11341 Nasr City /Cairo
info@peri.com.eg
www.peri.com.eg

54 India

PERI (India) Pvt Ltd
Mumbai – 400064
info@peri.in
www.peri.in

60 Albania

PERI Representative Office
Tirane
info@peri.com.tr
www.peri.com.tr

67 Philippines

PERI-Asia Philippines, INC.
Makati City
info@peri.com.ph
www.peri.com.ph

41 Bulgaria

PERI Bulgaria EOOD
1839 Sofia
peri.bulgaria@peri.bg
www.peri.bg

48 Serbia

PERI – Oplate d.o.o.
22310 Šimanovci
office@peri.rs
www.peri.rs

55 Jordan

PERI GmbH - Jordan
11947 Amman
jordan@peri.com
www.peri.com

61 Peru

PERI Peruana S.A.C.
Villa El Salvador, Lima
contacto@peri.com.pe
www.peri.com.pe

68 Hong Kong

PERI (Hong Kong) Limited
Hong Kong SAR, PRC
bob.dover@periasia.com
www.perihk.com

42 Iceland

Armar ehf.
220 Hafnarfjörður
armar@armar.is
www.armar.is

49 Mexico

PERI Cimbras y Andamios,
S.A. de C.V.
Estado de México, Huehuetoca
info@peri.com.mx
www.peri.com.mx

56 Kuwait

PERI Kuwait W.L.L.
13011 Kuwait
info@peri.com.kw
www.peri.com.kw

62 Panama

PERI Panama Inc.
0832-00155 Panama City
info@peri.com.pa
www.peri.com.pa

69 Namibia

PERI (Pty.) Ltd.
Windhoek
windhoek@peri.na
www.peri.na

43 Kazakhstan

TOO PERI Kazakhstan
050000 Almaty
peri@peri.kz
www.peri.kz

50 Azerbaijan

PERI Representative Office
Baku
peribaku@peri.com.tr
www.peri.com.tr

63 Angola

Pericofragens, Lda.
Luanda
renato.portugal@peri.pt
www.peri.pt

70 Mozambique

PERI (Pty.) Ltd.
Matola
maputo@peri.co.mz
www.peri.co.mz

The optimal System for every Project and every Requirement



Wall Formwork



Column Formwork



Slab Formwork



Climbing Systems



Tunnel Formwork



Bridge Formwork



Shoring Systems



Construction Scaffold



Facade Scaffold



Industrial Scaffold



Access



Protection Scaffold



System-Independent Accessories



Services



PERI GmbH
Formwork Scaffolding Engineering
 Rudolf-Diesel-Strasse 19
 89264 Weissenhorn
 Germany
 Tel. +49 (0)7309.950-0
 Fax +49 (0)7309.951-0
 info@peri.com
 www.peri.com